

Technical data sheet

Clamp clip 2056 H-foot, 1-fold, plastic pressure sleeve, A2

Item number: 1186369



Clamp clip with hammerhead foot, plastic pressure sleeve made of polypropylene. For vertical and horizontal mounting of 1 single cable on a C-profile rail. For a slot width 16–17 mm. With 1-start screw thread on pressure sleeve, universal hexagonal screw head WAF10, with slot and cross recess. Suitable for assembly indoors and outdoors. We recommend the use of a counter-sleeve.



A2 Stainless steel

2B Bright, treated

Master data

| | |
|------------------------------------|-------------------------|
| Item number | 1186369 |
| Type | BS-H1-K-70 A2 |
| Description 1 | Clamp clip 2056 |
| Manufacturer | OBO |
| Dimension | 64-70mm |
| Material | Stainless steel |
| Surface | Bright, treated |
| Surface standard | |
| Smallest sales unit | 15 |
| Unit of quantity | Piece |
| Weight | 18.2 kg |
| Weight unit | kg/100 pc. |
| CO2 Footprint (GWP) Cradle-to-Gate | 0,7657 kg COe / 1 Piece |

Technical data sheet

Clamp clip 2056 H-foot, 1-fold, plastic pressure sleeve, A2

Item number: 1186369



Dimensions

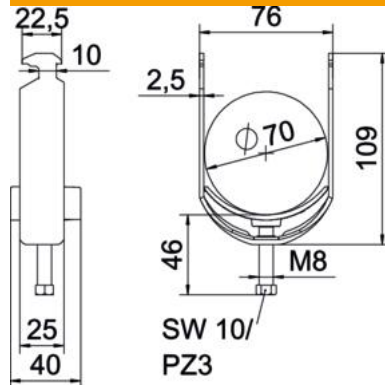

| | |
|------------------|--------|
| Length | 25 mm |
| Width | 76 mm |
| Height | 109 mm |
| Plate thickness | 2.5 mm |
| Dimension A | 25 mm |
| Dimension B | 76 mm |
| Dimension C | 40 mm |
| Dimension G (mm) | M8 |
| Dimension H | 109 mm |
| Dimension L | 45 mm |
| Dimension t | 2.5 mm |

Technical data

| | |
|--|-----------------|
| Number of cables/pipes | 1 |
| For pipe diameter, max. | 70 mm |
| For pipe diameter, min. | 64 mm |
| for rail with slot width (with interval), max. | 17 mm |
| for rail with slot width (with interval), min. | 16 mm |
| Thread | M8 |
| Halogen-free | yes |
| Length of external dimensions | 40 mm |
| Max. Tightening torque | 5 Nm |
| With plastic trough | yes |
| Mounting type | Profile rail |
| Slot width | 10 mm |
| Clamping range D, max. | 70 mm |
| Clamping range D, min. | 64 mm |
| Surface addition | Untreated |
| Material addition | Rustproof steel |
| With counter-trough | no |
| Material of trough | Plastic |
| Material quality of trough | Polypropylene |