

# Technical data sheet

## MS4121 mounting rail, slot 22 mm, A2, perforated

Item number: 1122928



Heavy-duty C profile rail for individual installation of support constructions, e.g. for cable trays or as a panel for switchgear cabinets. Can also be used for cable routing, in conjunction with clamp clips with a U foot.



**A2** Stainless steel

**2B** Bright, treated

### Master data

Item number	1122928
Type	MS4121P3000A2
Description 1	Profile rail
Description 2	perforated, slot 22mm
Manufacturer	OBO
Dimension	3000x41x21
Material	Stainless steel
Surface	Bright, treated
Surface standard	
Smallest sales unit	3
Unit of quantity	Metre
Weight	185.34 kg
Weight unit	kg/100 m
CO Footprint (GWP) Cradle-to-Gate	7,33 kg COe / 1 Meter

# Technical data sheet

## MS4121 mounting rail, slot 22 mm, A2, perforated

Item number: 1122928



### Dimensions

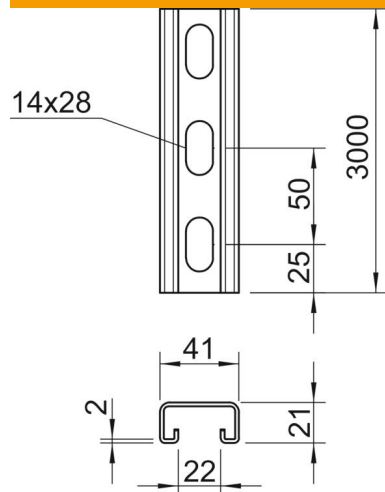

Length	3,000 mm
Width	41 mm
Height	21 mm
Dimension L	3,000 mm

### Technical data

Breakable	no
Type of perforation	Perforated back
Version for	Single profile
Drill hole spacing, centre	50 mm
Maintain electrical functions	no
Hole size	14x28 mm
Material thickness	2 mm
With perforation	yes
With toothing	yes
Profile shape	C profile
Slot width	22 mm
Static value A	1.65 cm <sup>2</sup>
Static value Iy	0.95 cm
Static value Iz	4.51 cm
Static value Wy	0.89 cm <sup>2</sup>
Static value Wz	2.2 cm <sup>2</sup>