

Technical data sheet

MS4121 mounting rail, slot 22 mm, A2, perforated

Item number: 1122929



Heavy-duty C profile rail for individual installation of support constructions, e.g. for cable trays or as a panel for switchgear cabinets. Can also be used for cable routing, in conjunction with clamp clips with a U foot.



A2	Stainless steel
2B	Bright, treated

Master data		
Item number	1122929	
Type	MS4121P6000A2	
Description 1	Profile rail	
Description 2	perforated, slot 22mm	
Manufacturer	OBO	
Dimension	6000x41x21	
Material	Stainless steel	
Surface	Bright, treated	
Surface standard		
Smallest sales unit	6	
Unit of quantity	Metre	
Weight	140.95 kg	
Weight unit	kg/100 m	
CO Footprint (GWP) Cradle-to-Gate	7,2924 kg COe / 1 Meter	

Technical data sheet

MS4121 mounting rail, slot 22 mm, A2, perforated

Item number: 1122929



Dimensions

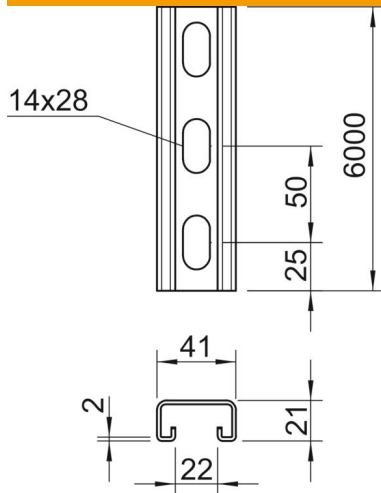

Length	6,000 mm
Width	41 mm
Height	21 mm
Dimension L	6,000 mm

Technical data

Breakable	no
Type of perforation	Perforated back
Version for	Single profile
Drill hole spacing, centre	50 mm
Maintain electrical functions	no
Hole size	14x28 mm
Material thickness	2 mm
With perforation	yes
With toothing	yes
Profile shape	C profile
Slot width	22 mm
Static value A	1.65 cm ²
Static value Iy	0.95 cm
Static value Iz	4.51 cm
Static value Wy	0.89 cm ²
Static value Wz	2.2 cm ²